

Cuneo 70

Cuneo 70

Tenda a rullo da interno con cassonetto di ingombro ridotto

Internal roller blind with reduced operating space cassette

Avvolgitore <i>Roller tube</i>	Materiale :	Tubo di alluminio estruso con ogiva	
	Material:	Extruded aluminium tube with recess	
Cassonetto <i>Cassette</i>	Materiale / Finitura:	Alluminio estruso verniciato a polveri	
	Material / Finishing:	Powder-coated extruded aluminium	
	Ispezionabile / Inspectable	No	
	Complementi:	Guarnizione a spazzola	
	Complements:	Seal brush	
Fondale <i>Bottom rail</i>	Materiale / Finitura:	Alluminio estruso verniciato a polveri	
	Material / Finishing:	Powder-coated extruded aluminium	
	Complementi:	Guarnizione a palloncino e zavorra in acciaio zincato	
	Complements:	Ballon seal and galvanised steel weight	
Guide <i>Guides</i>	Materiale / Finitura:	Alluminio estruso verniciato a polveri	
	Material / Finishing:	Powder-coated extruded aluminium	
	Ispezionabile / Inspectable	No	
Viteria <i>Screws</i>	Materiale:	Acciaio inossidabile	
	Material:	Stainless steel	
Manovre <i>Handlings</i>	Motore:	Corrente alternata AC a 230v / 14-16 rpm	
	Motor:	Alternating current AC 230v / 14-16 rpm	
	Argano:	Con giunto snodato, asta e manovella snodabile	
	Gear:	With folded joint, rod and folding crank handle	
Supporti <i>Brackets</i>	Finitura:	Zincatura	
	Finishing:	Galvanization	
Tipi d'installazione <i>Installation types</i>		A soffitto con supporti	
		Ceiling mounted with brackets	
		A parete con staffe frontali	
		Wall mounted with brackets	
Installazione guide <i>Guides installation</i>		Frontale/Front	
		In luce / In front of the window	
Dimensioni <i>Dimensions</i>	Larghezza / Width (mm):	600 min - 2200 max	
	Altezza / Height (mm):	In funzione del telo / Depending of the fabric	
		catena/argano	motore
	Libera / Without guides	3000 max	2400 max
	Con guide / With guides	2400 max	2200 max
Confezione telo <i>Fabric confectioning</i>		Bottoni in plastica	
		Plastic buttons	
		Steccature in acciaio inox	
		Stainless steel reinforcements	
		Inserito al tubo mediante tondino	
		Inserted to the tube by a rigid rod	
		Inserito al fondale mediante tondino	
		Inserted to the bottom rail by reinforcing rod	
Certificazione <i>Certification</i>		13561	

Contenuti extra / Extras

Puoi trovare maggiori informazioni e immagini visitando il sito:

For more information and images please visit our website at:

www.marinellotende.com/cuneo70

Ingombri tecnici Technical operating space

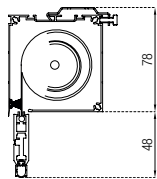

Fondale 11x41
Bottom rail 11x41

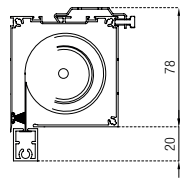

Fondale 15x20
Bottom rail 15x20

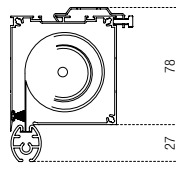

Fondale 19x23
Bottom rail 19x23

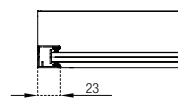

Guida 22x23
Guide 22x23

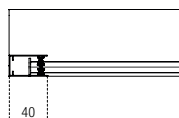

Guida 22x40
Guide 22x40

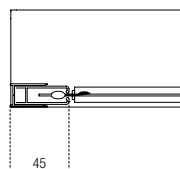

Guida telescopica
Telescopic guide



Guida 22x80
Guide 22x80

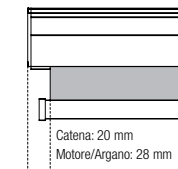

Tolleranza laterale del tessuto
Fabric lateral tolerance

Modalità d'installazione Handling modes

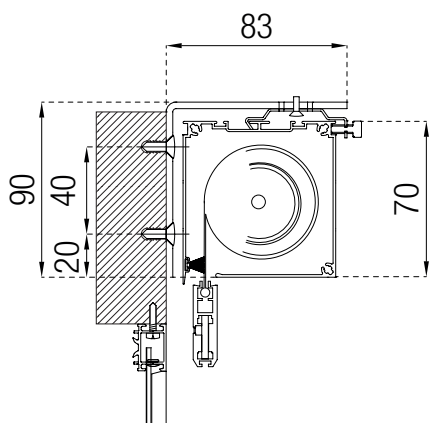

Montaggio a parete con staffa
Wall installation with bracket

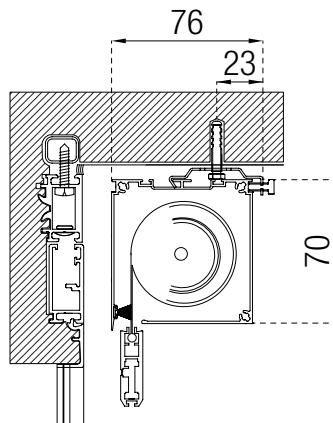

Montaggio a soffitto con supporto
Ceiling installation with bracket

Configurazioni Configurations



Libera
Without guide



Guida 22x40
Guide 22x40



Guida telescopica
Telescopic guide



Guida perlon
Perlon cable guide

Applicazioni particolari Special applications



Asta asportabile
Removable winding rod



Guida 22x23
Guide 22x23

Cassonetti Cassettes

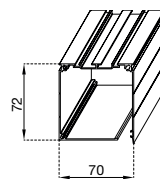

C70

Fondali Bottom rails

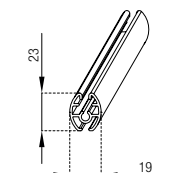

19x23

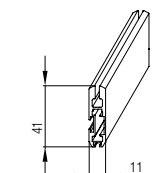

11x41

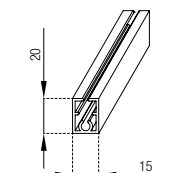

15x20

Guide Guides

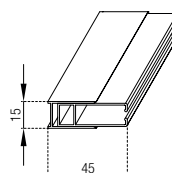

Telescopica

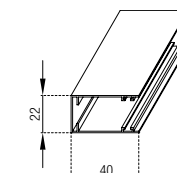

22x40

Avvolgitori Roller tubes

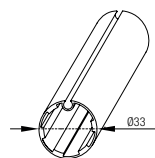

Ø33

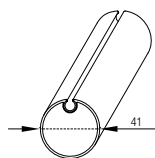

Ø41

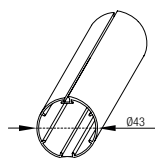

Ø43

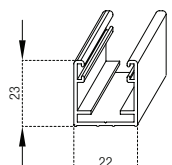

22x23

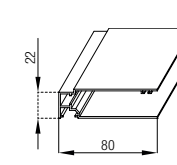

80x22



Viale Europa, 8 - 35020 Ponte San Nicolò - Padova - Italy
T. +39 049 8790160 - F. +39 049 8790102
www.marinellotende.com - info@marinellotende.com

Le informazioni contenute nel presente catalogo potrebbero risultare imprecise a causa delle possibili modifiche tecniche apportate successivamente alla stampa.
Il costruttore si riserva di apportare modifiche tecniche senza preavviso. Prima di effettuare l'ordine consulta il costruttore o il rivenditore di fiducia. La tenda Cuneo 70 è destinata alla protezione solare dell'ambiente nel quale è posizionata. Ogni altro uso è da considerarsi improprio e quindi irragionevole. Il costruttore Marinello Tende non può essere considerato responsabile per eventuali danni causati da usi impropri, erronei ed irragionevoli.
La tenda Cuneo 70 deve essere installata perpendicolare rispetto al piano orizzontale. In presenza di pericolo di formazione di ghiaccio la tenda a rullo non dev'essere azionata. In caso di forte vento è necessario avvolgere la tenda.
Il telo può presentare delle pieghe che non influiscono sul corretto funzionamento della tenda.

The contained information in this catalogue may be imprecise because of possible technical modifications made after printing.
The manufacturer reserves the right to make technical modifications without advance notice. Before making orders consult your manufacturer or retailer trusted.
The roller blind Cuneo 70 is designed for the sun protection of the space where it is located. Every other use is inappropriate and dangerous. Marinello Tende cannot be considered responsible for possible damages caused by improper, erroneous and unreasonable use.
The roller blind Cuneo 70 must be installed perpendicular to the horizontal area.
When the danger of icing is present the roller blind cannot be operated, in case of strong wind it is necessary to wrap up the roller blind.
The fabric can have folds that do not influence the proper functioning of the roller blind.